

# fens view

see the style, feel the quality  
at Fens View, Hallgate, Holbeach, Lincolnshire



a natural choice



Sovereign  
Reigns



# the plan

See for yourself what all the fuss is about, call in at Fens View today



Plots 3-10 are allocated to Community Housing. Plots 13/14, 17/18 are shared equity housing.



# the kenilworth and edinburgh

*We think you'll be impressed*



**Edinburgh**

**Kenilworth**

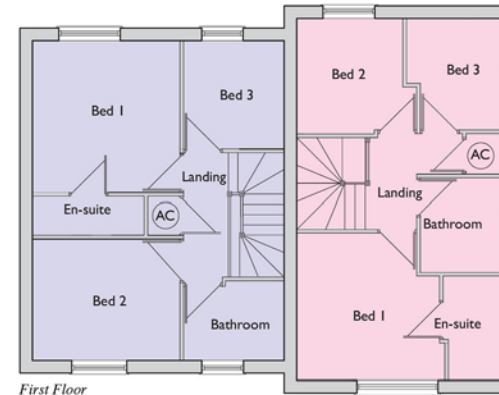

*First Floor*

**Edinburgh**

|               |                |               |
|---------------|----------------|---------------|
| Lounge/Dining | 3200* x 7000mm | 10'5" x 23'   |
| Kitchen       | 2700 x 3308mm  | 8'9" x 10'9"  |
| Bed 1         | 3220 x 3328mm  | 10'6" x 10'9" |
| Bed 2         | 3220 x 2662mm  | 10'6" x 8'7"  |
| Bed 3         | 2200 x 2266mm  | 7'2" x 7'4"   |
| Bath          | 2200 x 1905mm* | 7'2" x 6'3"   |
| En-suite      | 2440 x 850mm   | 8' x 2'8"     |

**Plots 1, 11, 12, 16, 19, 20, 22, 38**

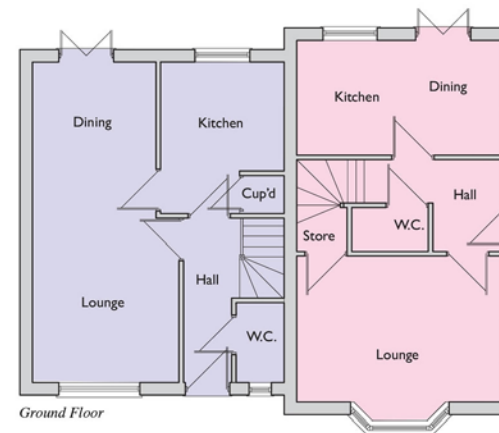

*Ground Floor*

**Kenilworth**

|                |                 |               |
|----------------|-----------------|---------------|
| Lounge         | 4500 x 3200mm   | 14'8" x 10'5" |
| Kitchen/Dining | 4500 x 2500mm   | 14'8" x 8'2"  |
| Bed 1          | 3235* x 3220mm  | 10'6" x 10'6" |
| Bed 2          | 2620* x 2520mm* | 8'6" x 8'3"   |
| Bed 3          | 2100* x 2420mm* | 6'9" x 7'9"   |
| Bath           | 1800 x 2060mm*  | 5'9" x 6'8"   |
| En-suite       | 1300* x 2280mm  | 4'3" x 7'5"   |

**Plots 2, 15, 21, 23, 37**

\*Max

